



# Caldwell

PROPERTY SERVICES



## 5 Friesland Avenue, Milton Keynes, MK8 1DX

### £460,000

This stunning, well-presented family home offers bright and spacious accommodation throughout.

The property features a light and airy lounge with a charming bay window, and a modern kitchen/diner complete with integrated appliances and a useful utility/cloakroom. Upstairs, the open landing leads to three generous double bedrooms, with the principal bedroom benefiting from fitted wardrobes and an en-suite shower room. A well-appointed family bathroom serves the remaining bedrooms.

AGENTS NOTE. The homeowner is interested in selling the majority of the furniture for approximately £5,000.

Outside, there is an attractive, low-maintenance rear garden, along with a large driveway providing parking for two vehicles and an additional parking space to the front.

A home full of character and warmth — early viewing is highly recommended.

Situated within the highly desirable Whitehouse Park development, the property also falls within an excellent school catchment area and offers convenient access to local amenities and green spaces.

## **ENTRANCE HALL**

Front entrance door. Stairs to first floor. Understairs storage area. Door to living room, kitchen/diner and utility cloakroom. Radiator. Skimmed ceiling.

## **CLOAKROOM**

Two piece suite comprising low level wc and wash hand basin. Radiator. Skimmed ceiling. Extractor. Understairs storage cupboard. Built in washing machine. Skimmed ceiling. Radiator.

## **KITCHEN/DINING ROOM 10'9" x 18'1" (3.30 x 5.53)**

Double glazed bay window to front aspect. Double glazed window to side. Double glazed French doors to side. Fitted with a range of soft close wall and base units with roll top worksurfaces incorporating one and half bowl sink drainer and mixer tap. Built double oven and four ring hob with extractor hood. Built in fridge freezer and dishwasher. Skimmed ceiling. Under unit lighting. Two double panelled radiators.

## **LIVING ROOM 18'0" x 10'10" (5.49 x 3.32)**

Double glazed bay window to front and double glazed window to side. Two double panelled radiators. Skimmed ceiling.

## **FIRST FLOOR LANDING**

Doors to all rooms. Double glazed window to front. Radiator. Skimmed ceiling.

## **BEDROOM ONE 12'0" x 11'7" (3.67 x 3.55)**

Double door built in wardrobe. Double glazed window to front. Double panelled radiator. Skimmed ceiling.

## **ENSUITE**

Three piece suite comprising double tiled shower cubicle with wall mounted shower, low level wc and wash hand basin, Frosted double glazed window to side. Inset lighting. Extractor. Tiled flooring. Heated chrome towel rail. Shaver point.

## **BEDROOM TWO 10'11" x 11'0" (3.33 x 3.36)**

Double glazed bay window to front. Double panelled radiator. Skimmed ceiling.

## **BEDROOM THREE 6'10" x 10'11" (2.10 x 3.33)**

Double glazed window to side. Double panelled radiator. Skimmed ceiling.

## **BATHROOM**

Double glazed. Three piece suite comprising panelled bath with shower over, low level wc and wash hand basin. Heated towel rail. Part tiled walls. Tiled flooring. Skimmed ceiling. Inset lighting. Extractor.

## **REAR GARDEN**

Enclosed rear garden, laid mainly to lawn with brick and wooden fence surround. Gated side access. Patio area.

## **FRONT GARDEN**

Block paved driveway with parking for several vehicles. Outside lighting. Path to front door. Wrought iron fence surround.

All measurements are approximate.

The area measurements are taken from the government EPC register.

The mention of appliances and/or services within these sales particulars does not imply that they are in full efficient working order. Please note that any services, heating systems or appliances have not been tested and no warranty can be given or implied as to their working order. **MORTGAGE & FINANCIAL** - The Mortgage Store can provide you with up to the minute information on all available rates. To arrange an appointment, telephone this office **YOUR HOME IS AT RISK IF YOU DO NOT KEEP UP REPAYMENTS ON A MORTGAGE OR OTHER LOANS SECURED ON IT**. Full quotation available on request. A suitable life policy may be required. Loans subject to status. Minimum age 18.

We routinely refer customers to Franklins solicitors, Gough Thorne and The Mortgage Store. It is your decision whether you choose to deal with them, in making that decision, you should know that we receive a referral fee in the region of £80 to £250 for recommending you to them.

All clients are subject to identity and source of funds checks. We use a third party company to complete these for us. The charge is £60 inc vat per transaction which requires to be paid at your earliest convenience once your offer has been accepted, this enables us to conduct the verification checks we are obliged to do as per HMRC Anti Money Laundering guidelines.

# Floor Plan

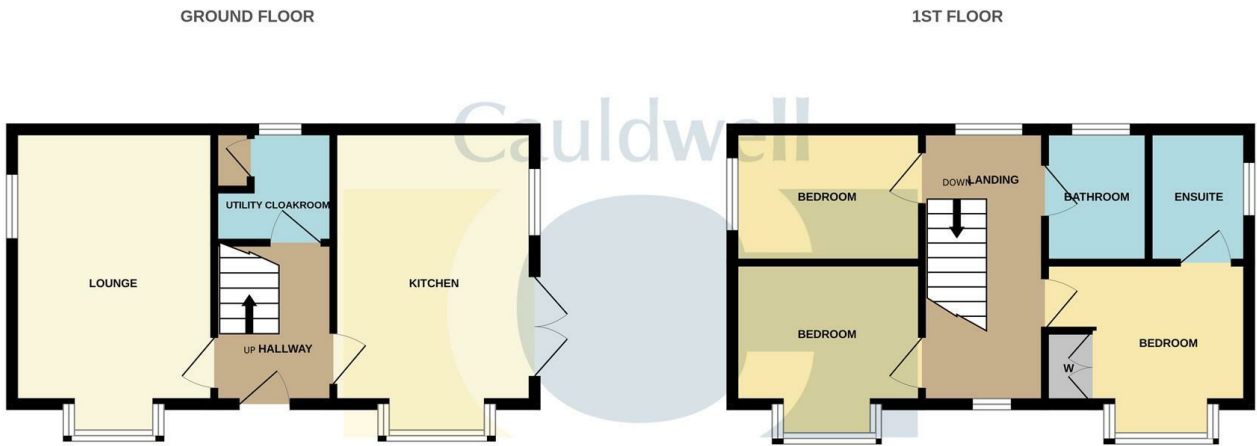

PROPERTY SERVICES

TOTAL FLOOR AREA : 969sq.ft. (90.0 sq.m.) approx.

Whilst every attempt has been made to ensure the accuracy of the floorplan contained here, measurements of doors, windows, rooms and any other items are approximate and no responsibility is taken for any error, omission or mis-statement. This plan is for illustrative purposes only and should be used as such by any prospective purchaser. The services, systems and appliances shown have not been tested and no guarantee as to their operability or efficiency can be given.  
Made with Metropix ©2026

# Area Map

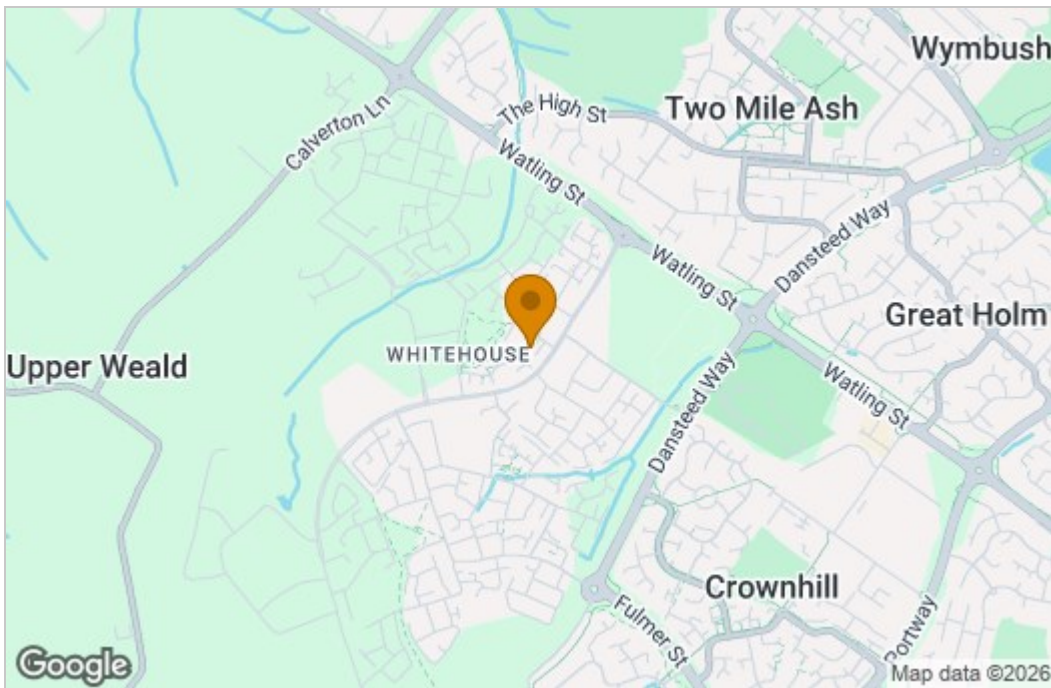

# Energy Efficiency Graph

Energy Efficiency Rating		Current	Potential
Very energy efficient - lower running costs			
(92 plus) A			94
(81-91) B		83	
(69-80) C			
(55-68) D			
(39-54) E			
(21-38) F			
(1-20) G			
Not energy efficient - higher running costs			
England & Wales		EU Directive 2002/91/EC	

These particulars, whilst believed to be accurate are set out as a general outline only for guidance and do not constitute any part of an offer or contract. Intending purchasers should not rely on them as statements of representation of fact, but must satisfy themselves by inspection or otherwise as to their accuracy. No person in this firm's employment has the authority to make or give any representation or warranty in respect of the property.